

To,

The Principal

Greenfield School

At/Po-Palaspanga

Dist-Keonjhar,Odisha

School Udise Code-21061015252

CBSE Affiliation No-1530024

School No-15370

Sub:- School building safety inspection report in favour of Greenfield School,Palaspanga,Keonjhar

Respected Sir/Madam,

With reference to the subject cited above this is to intimate that as per Plan school is functioning in 5 no. of buildings. All the buildings are of single storied . Built up area of block -1 is 246.4 sqm, block -2-553 sqm,block-3-301 sqm block-4-257.8 sqm and block five office building is of 233.5 sqm. All the buildings are separated from each other and adequate open space is available. The height of each building is less than 9mtrs .It is R.C.C framed structure Building .The rooms of the buildings are safety condition for smooth running of the classes.

I, certify that I have inspected the Greenfield school , Palaspanga building on 24/02/2021 referred to above and examined the various parts including the foundations with special reference to the class rooms. I am of the opinion that the buildings are in accordance with the plans. These buildings are structurally sound and stability will not be endangered by their use as school.

Chaturbhuj Nayak

Assista. Engineer
Sadar B.K. Keonjhar

Sadar Block,Keonjhar

Keonjhar

EXISTING SCHOOL BUILDING PLAN OF GREEN FIELD SCHOOL, OVER PLOT NO.44 & KHATA NO.21, MOUZA - SPONGE PATNA, P.S. - SADAR NO.301, IN THE DISTRICT OF KEONJHAR
(SCALE= NOT TO SCALE)



ELEVATION BLOCK-1



ELEVATION BLOCK-2



ELEVATION BLOCK-3



GROUND FLOOR PLAN OF BLOCK-1

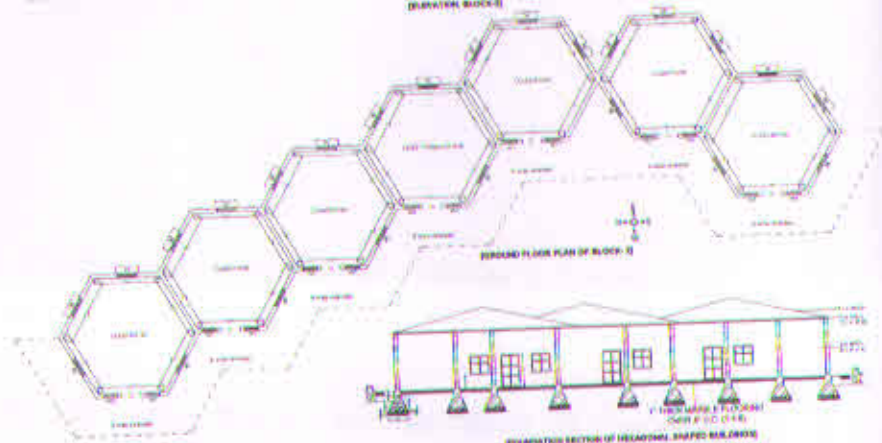

GROUND FLOOR PLAN OF BLOCK-2



GROUND FLOOR PLAN OF BLOCK-3



FOUNDATION SECTION OF EXISTING SHAFTED BUILDING



ELEVATION BLOCK-4



ELEVATION



FOUNDATION SECTION



ELEVATION



ELEVATION

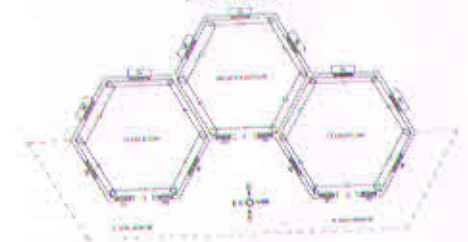

GROUND FLOOR PLAN OF BLOCK-4



GROUND FLOOR PLAN OFFICE BUILDING



GROUND FLOOR PLAN OF SMALL BUILDING



GROUND FLOOR PLAN OF SMALL BUILDING



FLOOR PLAN OF SMALL BUILDING

REFERENCE
1/11 DOOR: 47/107
1/11 WINDOW: 32/107
1/11 WINDOW: 32/107
1/11 WINDOW: 47/107

AREA STATEMENT	
BLOCK 1- PLINTH AREA	2833 SQ. FT.
BLOCK 2- PLINTH AREA	1883 SQ. FT.
BLOCK 3- PLINTH AREA	3244 SQ. FT.
BLOCK 4- PLINTH AREA	3775 SQ. FT.
OFFICE BUILDING- PLINTH AREA	2014 SQ. FT.
OLD PRINCIPAL OFFICE- PLINTH AREA	800 SQ. FT.
TOTAL PLAN- PLINTH AREA	8011 SQ. FT.
TOTAL AREA	30986 SQ. FT.
TOTAL BUILT UP AREA	19140 SQ. FT.

Signature of Applicant

Drawn by: A. Anand
Scale: 1/4" = 1'-0"

(Signature)
Assistant Engineer
Sadar Block, Keonjhar